

INSIDE VIEW

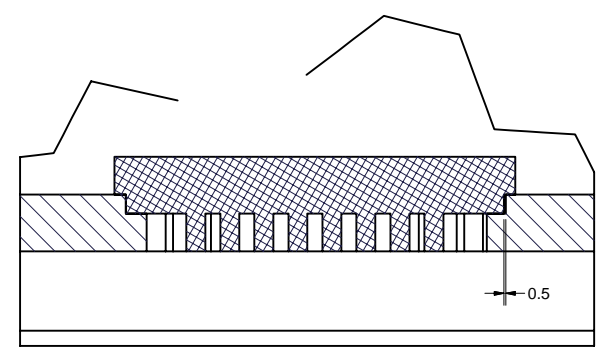

SECTION E-E
SCALE: 1:1

1 TPC LARGE PROTOTYPE
 FILE NAME: 6080-014
 SHEET NO.: 2
 DFT. SCALE: AS NOTED
 MATERIAL: AS NOTED
 QTY: AS NEEDED
 NOTES:

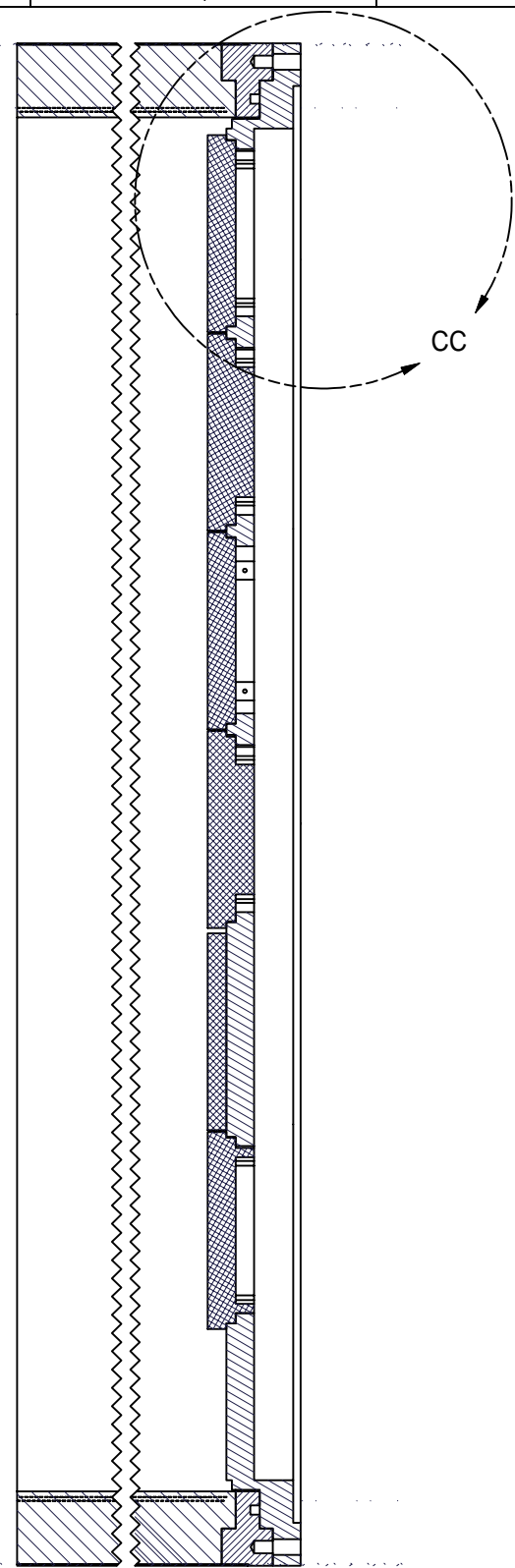

SECTION BB-BB
SCALE 1/2

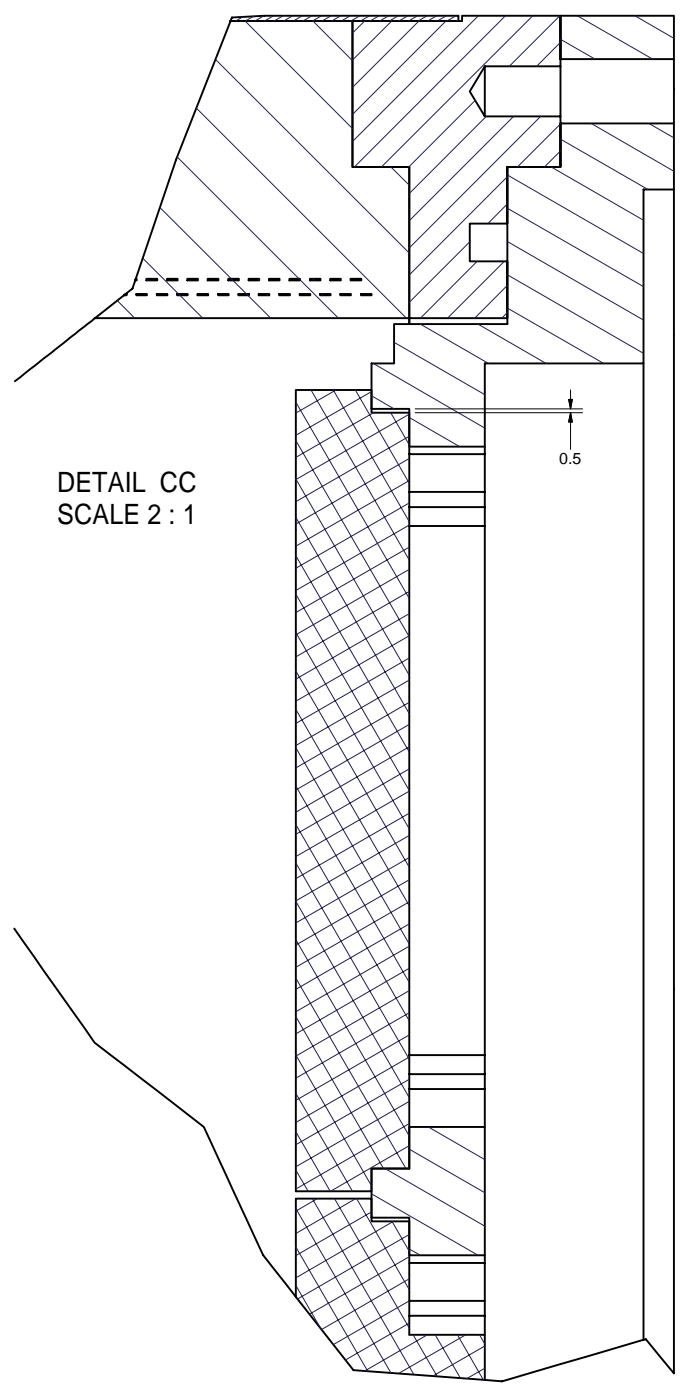

DETAIL CC
SCALE 2:1

GENERAL NOTE - ALL SHEETS: ALL DIMS ARE IN mm.

FOR MACHINING LUBRICANT USE ONLY
 ALKALINE DETERGENT LUBRICANT CIMSTAR 40
 OR EQUIVALENT APPROVED BY CORNELL LEPP

REVISIONS		DATE	APP.
SYM.	ZONE	DESCRIPTION	

ITEM	DWG. NO.	DESCRIPTION	G1	G2	G3	REMARKS	REV.	
			QUANTITY					
PRINT DISTR.	PLOT DATE: 4/5/2006 CAD FILE NAME: 6080-014.idw							
6080-014 SH. NO. 2 OF 9	CR-1	UNLESS OTHERWISE SPECIFIED: DIMENSIONS ARE IN INCHES: TOLERANCES ON: .00 ± .010 .000 ± .005 FRACTIONS ± 1/64 ANGLES ± 0.5° ALL SURFACES ✓	 CORNELL UNIVERSITY FLOYD R. NEWMAN LABORATORY ITHACA, NY 14853		Linear Collider R&D, TPC Large Prototype Assembly			
CHECKED BY:	DRAWN BY TMK	DRAWN FOR DPP	DATE 4/4/2006	SCALE D	6080-014 SH. NO. 2 OF 9	REV.		