

REVISIONS		
SYM	ZONE	DATE

NOTE: Shown with:
 Bolt Circle Radius = 375mm
 Bolt Diameter = 6mm
 O Ring Groove Outer Radius = 367mm
 O Ring Groove Width = 3.65mm , Depth 2.75mm
 For 3.55mm O Ring

**DETAIL CC
 SCALE 2:1**

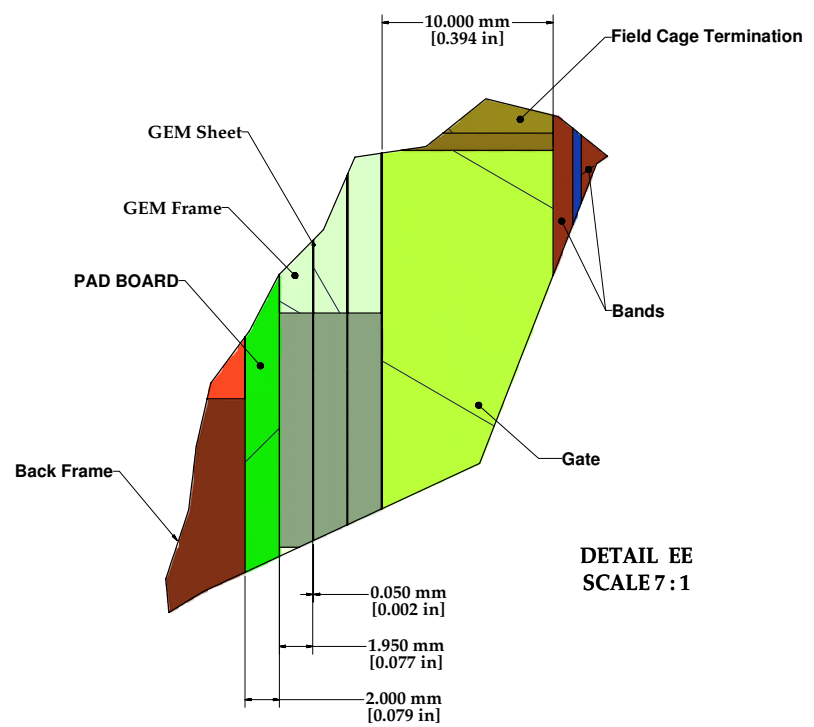
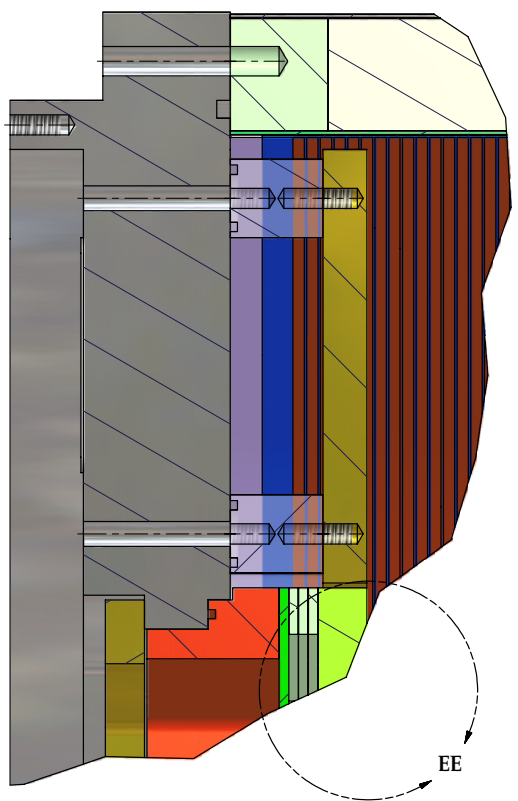

**DETAIL EE
 SCALE 7:1**

FOR MACHINING LUBRICANT USE ONLY
 ALKALINE DETERGENT LUBRICANT CIMSTAR 40
 OR EQUIVALENT APPROVED BY CORNELL LEPP

TECHNICAL RESOURCE APPROVALS REQUIRED BEFORE FABRICATION			
	OK	DATE	N/A
DRAFTING (O'Connell):			
MACHINE SHOP (Kammeski):			
CHEMISTRY (Cankkitt):			
ELECTRONICS SHOP (Barley):			
FURNACE BRAZING (Sherwood):			
BEAM WELDING (Seans):			
WELDING OTHER (Gallagher):			
UTILITIES INTEGRATION (Gallagher):			
STOCKROOMS (Lockwood):			

ITEM	DWG. NO.	DESCRIPTION	G1	G2	G3	REMARKS	REV.
			QUANTITY				
PRINT DISTR.	6080-112	PLOT DATE: 2/21/2008 CAD FILE NAME: 6080-112.kdw					
UNLESS OTHERWISE SPECIFIED: DIMENSIONS ARE IN INCHES: TOLERANCES ON: .00 & .01 .000 ± .005 .02 & .05 .000 ± .010 FRACTIONS > 1/16 .000 ± .010 ANGLES ± 0.5 ALL SURFACES ✓							
CORNELL UNIVERSITY LEPP LABORATORY FOR ELEMENTARY PARTICLE PHYSICS			CORNELL UNIVERSITY Floyd R. Newman Laboratory Ithaca, NY 14853				
End Plate, 3GEM, & Field Cage Assm							
DESIGNED BY: Peterson	DRAWN BY: MDS	DRAWN FOR: Peterson	DATE: 12/4/2007	SCALE: D	6080-112		
APPROVED BY: Peterson					SH. NO. 3	OF 4	REV.